

# ***griptech***

## KOOI® REACHFORKS | RG2/RG4

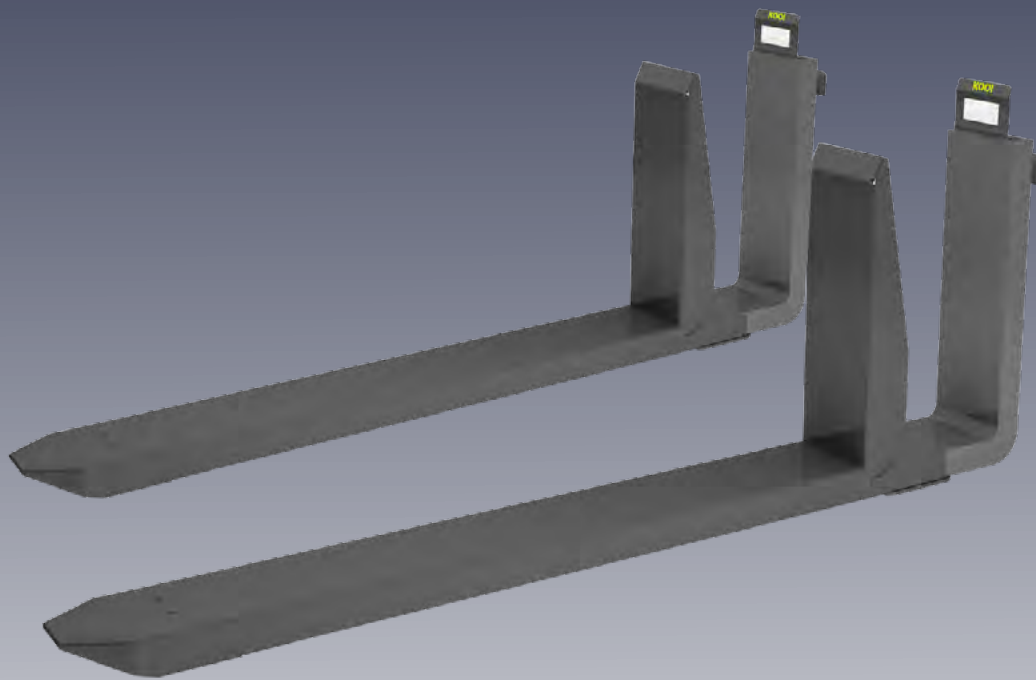

### Features:

- ▶ For retraction and extension with load
- ▶ RG2: 1-cylinder version with increased working speed
- ▶ RG4: 2-cylinder version „high-performance model“ up to 40,000 kg load capacity
- ▶ Base fork with triple safety
- ▶ Simple installation and calibration

Attachments

Weighing systems

Camera systems

# KOOI® REACHFORKS | RG2/RG4

100,000 pairs sold: KOOI® Reachforks proven quality since 1980

- ▶ 100% forced synchronization
- ▶ 1 or 2-cylinder (high-performance model) in each fork tine
- ▶ 6 mm thick wear strip integrated in the outer fork: The most wear-resistant outer fork on the market!

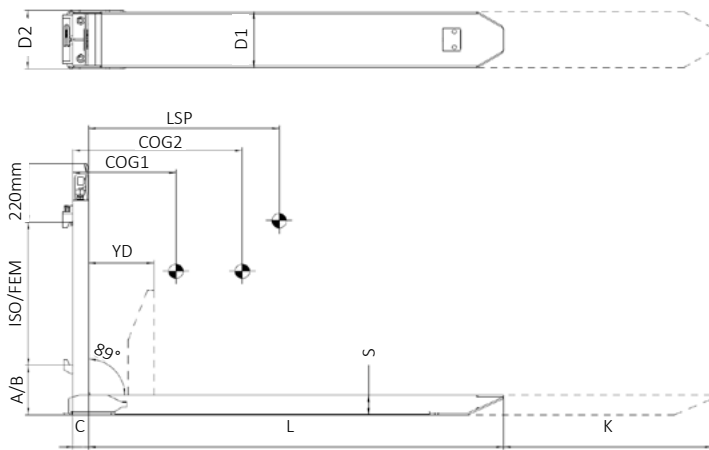

## Version with 100% forced synchronization (1 function)

| Series  | Length L/K mm | Capacity in kg/LC |           | ISO/ FEM | For forklifts load cap. of up to | Cross section D1/ D2xS mm | C mm | COG1/COG2 mm | Weight/pair kg |
|---|---------------|-------------------|-----------|----------|----------------------------------|---------------------------|------|--------------|----------------|
|   |               | retracted         | extended  |          |                                  |                           |      |              |                |
| <b>1 cylinder design extra narrow and increased working speed</b> |               |                   |           |          |                                  |                           |      |              |                |
| RG2 20  | 1100/750      |                   | 925/1300  |          |                                  |                           |      | 370/535      | 150            |
| RG2 20  | 1200/850      | 2000/600          | 825/1450  | 2A       | 1,8 t                            | 131/139x57                | 45   | 415/605      | 160            |
| RG2 20  | 1350/1000     |                   | 685/1750  |          |                                  |                           |      | 485/710      | 175            |
| RG2 25  | 1100/750      |                   | 1150/1300 |          |                                  |                           |      | 350/508      | 157            |
| RG2 25  | 1200/850      | 2500/600          | 1035/1450 | 2A       | 2,0 t                            | 131/139x57                | 45   | 395/580      | 166            |
| RG2 25  | 1350/1000     |                   | 855/1750  |          |                                  |                           |      | 460/680      | 180            |
| RGN2 30   | 1100/750      |                   | 1380/1300 |          |                                  |                           |      | 375/525      | 165            |
| RGN2 30   | 1200/850      | 3000/600          | 1250/1450 | 3A       | 2,5 t                            | 131/139x62                | 50   | 420/590      | 175            |
| RGN2 30   | 1350/1000     |                   | 1025/1750 |          |                                  |                           |      | 485/695      | 190            |
| <b>'High performance model' 2 cylinders in each fork</b>          |               |                   |           |          |                                  |                           |      |              |                |
| RG4 25  | 1100/750      |                   | 1150/1300 |          |                                  |                           |      | 365/535      | 180            |
| RG4 25  | 1200/850      | 2500/600          | 1025/1450 | 2A       | 2,0 t                            | 161/169x57                | 45   | 410/610      | 190            |
| RG4 25  | 1350/1000     |                   | 857/1750  |          |                                  |                           |      | 475/720      | 210            |
| RG4 35  | 1100/750      |                   | 1615/1300 |          |                                  |                           |      | 365/540      | 180            |
| RG4 35  | 1200/850      | 3500/600          | 1450/1450 | 2A/3A    | 3,2 t                            | 161/169x57                | 45   | 410/610      | 190            |
| RG4 35  | 1350/1000     |                   | 1200/1750 |          |                                  |                           |      | 475/720      | 210            |
| RG4 45  | 1100/750      |                   | 2075/1300 |          |                                  |                           |      | 345/510      | 190            |
| RG4 45  | 1200/850      | 4500/600          | 1850/1450 | 3A       | 4,0 t                            | 161/169x57                | 45   | 390/575      | 200            |
| RG4 45  | 1350/1000     |                   | 1550/1750 |          |                                  |                           |      | 450/685      | 220            |
| RG4 58  | 1200/850      | 5800/600          | 2400/1450 | 3A/4A    | 5,0 t                            | 161/169x62                | 50   | 390/566      | 220            |
| RG4 58  | 1350/1000     |                   | 1990/1750 |          |                                  |                           |      | 455/670      | 240            |
| RG4 77  | 1200/850      | 7700/600          | 3180/1450 | 4A       | 6,0 t                            | 215/227x68                | 50   | 370/565      | 345            |
| RG4 77  | 1350/1000     |                   | 2640/1750 |          |                                  |                           |      | 435/670      | 375            |
| RG4 105   | 1200/850      | 10500/600         | 4300/1450 | 4A       | 8,0 t                            | 215/227x76                | 60   | 425/620      | 405            |
| RG4 105   | 1350/1000     |                   | 3600/1750 |          |                                  |                           |      | 440/610      | 440            |