

griptech

WEIGHING FORKS | WG-HD

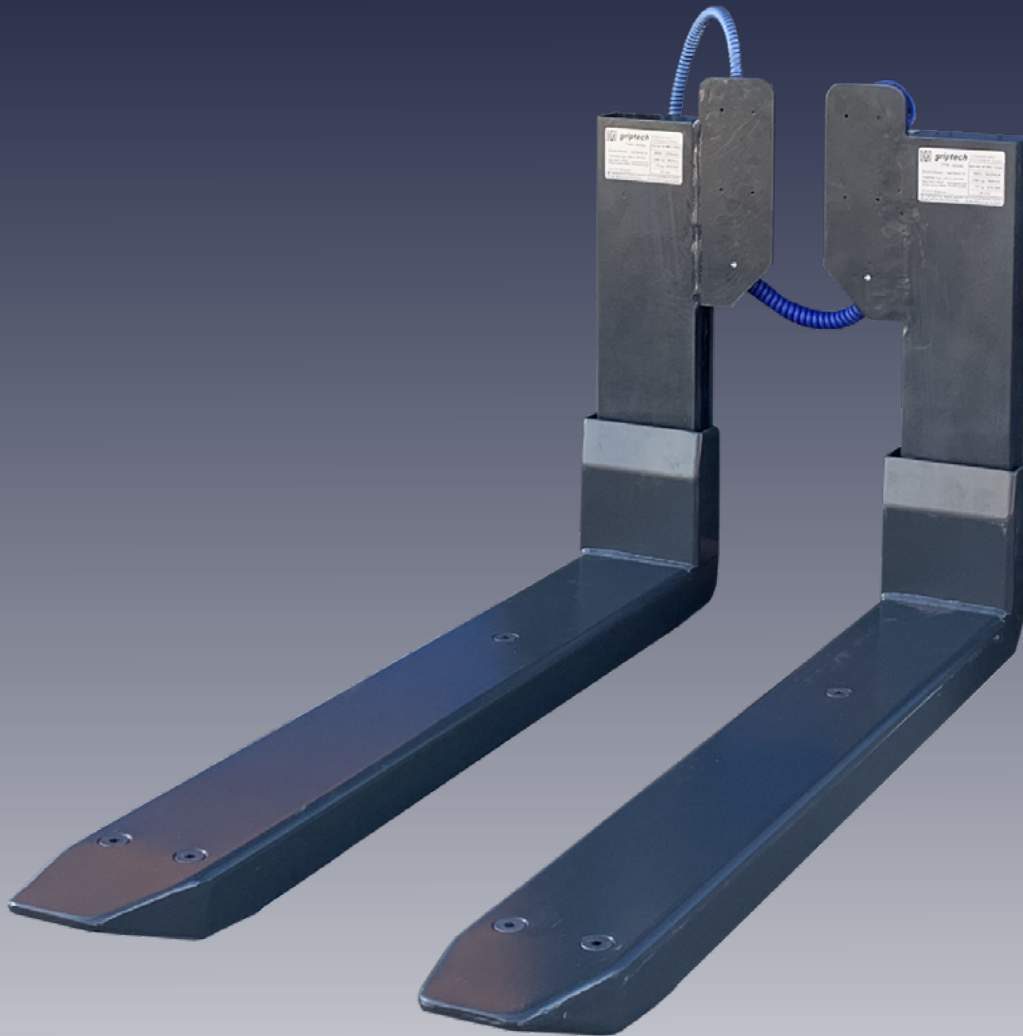

Attachments

Weighing systems

Camera systems

Features

- ▶ **OptimaForkHeel:** Up to 3 times longer service life and reduced deflection
- ▶ Signal transmission via radio, spiral or mast cable connection
- ▶ Weighing at any lift height
- ▶ 3 load cells in each fork arm ensure high accuracy
- ▶ Legal for trade version incl. calibration certificate according to class III

WEIGHING FORKS | WG-HD

Accuracy $\pm 0.1\%$ of the applied load

Weighing forks can be attached to any forklift truck with an FEM fork carriage. The weighing accuracy is very high and the system is designed in such a way that the relatively rough forklift use cannot damage the weighing technology. Signal transmission is standard via radio or spiral cable. The legal for trade version is only available with a cable connection. Also available in combination with a fork positioner.

Features:

- › Signal transmission via radio, spiral or mast cable connection
- › With wireless transmission: fast and cost-effective installation (Battery and transmitter provide up to 125 operating hours on a single charge)
- › Weighing at any lift height
- › OptimaForkHeel: Up to 3 times longer service life and reduced deflection – manufactured by Vetter
- › 3 load cells in each fork arm ensure high accuracy
- › Stable base fork corresponds to 3-fold safety
- › Legal for trade version incl. calibration certificate according to class III and tilt sensor
- › Protection class IP 65
- › Cable version with high-quality Griptech signal cable, including installation kit

Options:

- › Indicator with numeric keypad and special functions (R420)
- › Printer and data transfer
- › Voltage converter for 12 - 48 volts. (output voltage 12 V) incl. stabilization filter, IP 67
- › Relay circuit with 250 VAC / 3 A control signal, supplied with cable and connector (without adding function)
- › RS232 interface incl. connection cable and Sub-D connector
- › Extra exchangeable battery for radio transmission (active for up to 125 operating hours)
- › Stainless steel shoes and stainless steel load cells

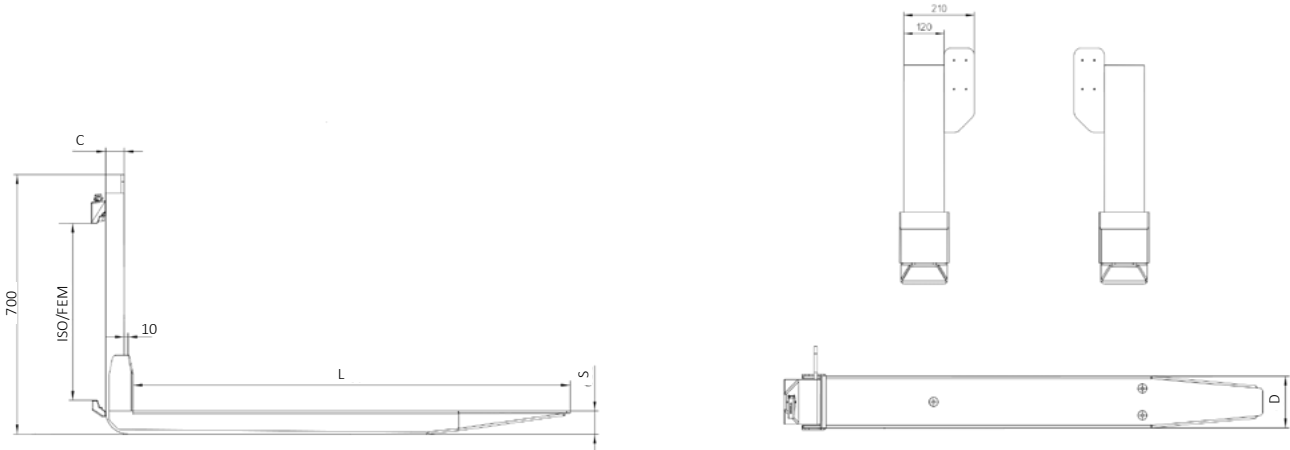

„Heavy Duty“ with 6 load cells and increased load capacity

Series	Load capacity kg/pair at mm LC	ISO/ FEM*	Effective length L mm	Cross section DxS mm	Display arrangement kg	C mm	COG mm	Weight/per pair kg
Standard version (Indicator R320)								
WG-HD 25	2500/600	IIA	1180	140 x 65	per 1 kg**	70	440	175
WG-HD 35	3500/600	IIIA	1180	140 x 65	per 2 kg**	70	460	187
WG-HD-50	5000/600	IIIA/IVA	1180	185 x 65	per 5 kg**	70	370	260
Legal for trade according to class III (Indicator R320)								
WG-HD-E 25	2500/600	IIA	1180	140 x 65	per 2 kg (1250 parts)	70	440	175
WG-HD-E 35	3500/600	IIIA	1180	140 x 65	per 5 kg (700 parts)	70	460	187
WG-HD-E 50	5000/600	IIIA/IVA	1180	185 x 65	per 5 kg (1500 parts)	70	370	260

